

## DS-2CD802/812/892P(N)-IR1/IR3/IR5 IR Bullet Network Camera

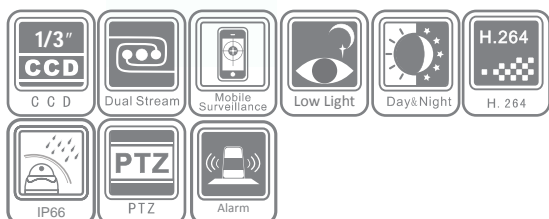

### Key features

- High performance 1/3" Sony CCD
- H.264 video compression
- Dual stream real time video
- Support PTZ control
- Day / night auto switch
- IP66 rating

### Dimensions

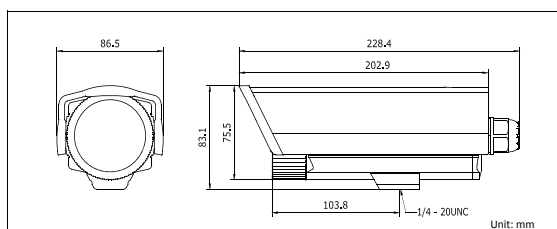

### Accessories



DS-1212ZJ  
(Indoor wall mount)



DS-1213ZJ  
(Indoor/Outdoor Wall Mount)

### Specifications

	DS-2CD802P(N)-IR1/IR3/IR5	DS-2CD812P(N)-IR1/IR3/IR5	DS-2CD892P(N)-IR1/IR3/IR5
<b>Camera</b>			
Image sensor	1/3" Sony CCD		
Signal system	PAL / NTSC		
Min. illumination	0.1 lux@F1.2, AGC on, 0 lux with IR 0.2 lux@F1.8, AGC on, 0 lux with IR		
Shutter time	1/50 (1/60)s ~ 1/100,000s		
Lens	"-IR1" series: 6mm @F1.8 (2.8mm, 3.6mm optional), angle of view: 47° (6mm) "-IR3" series: 12mm @F1.8 (3.6mm, 6mm, 8mm, 16mm optional), angle of view: 22.72° (6mm) "-IR5" series: 16mm @F1.8 (3.6mm, 6mm, 8mm, 12mm optional), angle of view: 16.4° (6mm)		
Lens mount	M12		
Day & night	Electronic		
Horizontal resolution	420 TVL	480 TVL	540 TVL
<b>Compression standard</b>			
Video compression	H.264 (MPEG-4 optional)		
Bit rate	32 Kbps ~ 8 Mbps		
Audio compression	OggVorbis		
Dual stream	Yes		
<b>Image</b>			
Max. image resolution	PAL: 704 × 576 NTSC: 704 × 480		
Frame rate	50 Hz: 25 fps (704 × 576) 60 Hz: 30 fps (704 × 480)		
Image settings	Saturation, brightness, contrast adjustable through client software or web browser		
<b>Network</b>			
Alarm trigger	Motion detection		
Protocols	TCP/IP, HTTP, DHCP, DNS, RTP/RTSP, PPPoE (FTP, SMTP, NTP, SNMP optional)		
Security	Password protection		
<b>Interface</b>			
Audio input	1-ch, 3.5mm audio interface (2.0 - 2.4 Vp-p, 1 kΩ)		
Audio output	1-ch, 3.5mm audio interface (line level, 600 Ω)		
Communication interface	1 RJ45 10M / 100M ethernet port and 1 RS-485 interface		
Alarm input	1		
Alarm output	1		
Video output	1 Vp-p composite output (75 Ω/BNC)		
<b>General</b>			
Operating conditions	-10°C ~ 60°C (14°F ~ 140°F) Humidity 90% or less (non-condensing)		
Power supply	12 VDC ± 10%		
Power consumption	"-IR1" series: 5.5W max. "-IR3" series: 7W max. "-IR5" series: 9W max.		
Weather proof rating	IP66		
IR range	"-IR1" series: 10 - 20m "-IR3" series: 30 - 40m "-IR5" series: 50 - 60m		
Dimensions	86.5 × 83.1 × 228.4mm (3.41" × 3.27" × 8.99")		
Weight	1400g (3.09 lbs)		

### Available models

DS-2CD802P-IR1/IR3/IR5, DS-2CD802N-IR1/IR3/IR5, DS-2CD812P-IR1/IR3/IR5  
DS-2CD812N-IR1/IR3/IR5, DS-2CD892P-IR1/IR3/IR5, DS-2CD892N-IR1/IR3/IR5