

HD5

SUPER HIGH RESOLUTION, DAY/NIGHT OR ULTRA WIDE DYNAMIC COLOR INDOOR MINI-DOME CAMERAS

Honeywell's HD5 Series of indoor fixed dome cameras is ideal for discreet fixed camera surveillance where high-quality video is a necessity. Each unit packages a high-performance camera and a full-sized CS mount lens into a small, aesthetically pleasing 5-inch dome. In-ceiling and pendant dome options are available with black or white trim ring finishes, and smoke or clear lower domes.

The HD5 is highly customizable for your needs. There are three camera models to choose from: the super high-resolution 540 TVL camera; a Wide Dynamic Range camera that uses the Digital Pixel System® (DPS) sensor technology; and a 540 TVL Digital Noise Reduction (DNR) technology to produce extremely sharp and clear images regardless of lighting levels. DNR removes noise artifacts, increasing the performance of motion detection and typically providing longer recording durations on digital and network video recorders.

Easy accessible switches on the top of the camera make setup quick. The HD5U and the HD5SD also come with a one-button camera setup lever control to access the on-screen display menu. The compact flush one-piece mount design allows for fast, easy installation. A pendant mount and standard 4x4 electrical box kit is available for inconspicuous installation in virtually any application. A service/monitor cable is also included for easy on-site adjustments.

The HD5 is equipped, depending on your needs, with either a 2.7-13.5 mm or 5-50 mm Vari-focal Auto Iris or Manual Iris lens to cover a wide range of viewing angles. This is supplemented by easy picture adjustment via the 3-D axis gimbal that is capable of 360° of pan, 180° of tilt and 360° of horizontal rotation.

The HD5 accepts either 12 VDC or 24 VAC (auto sensing) for proper operation and flexible installation. In addition, the HD5 Series is available in two transmission media (Coaxial or UTP) integrated inside the camera.

Market Opportunities

The HD5 is a general surveillance solution designed for object recognition required in locations where variable light and low light conditions exist. True color reproduction and excellent low light performance result in enhanced picture quality. Attractive cosmetic appearance makes HD5 Series dome cameras the ideal solution for a wide range of surveillance applications such as retail sites, casinos, banks, malls, residential applications or hotel lobbies – anywhere surveillance must be discreet.

Features

- 1/3" Sony HAD CCD™ or Ultra Wide Dynamic DPS imager
- Models available: 540 TVL, 540 TVL Day/Night with DNR and 540 TVL Wide Dynamic
- Vari-focal lenses available:
2.7-13.5 mm or 5-50 mm Auto Iris lenses, 2.7-13.5 mm or 5-50 mm Manual Iris lenses
- Pendant and back box mount kits available
- Black or white trim-ring finishes available
- Smoke or clear domes available
- Dual 12 VDC/24 VAC
- Local video output for setup
- Two transmission media (Coaxial, UTP) integrated inside the camera



HD5 Series
(Black shown)

SPECIFICATIONS

| Operational | HD5CH, HD5CHTP/ HD5CHX, HD5CHTPX | HD5U, HD5UTP/ HD5UX, HD5UTPX | HD5SD, HD5SDTP/ HD5SDX, HD5SDTPX |
|------------------------------|--|--|--|
| Video Standard | NTSC/PAL | NTSC/PAL | NTSC/PAL |
| Scanning System | 525 lines, 2:1; 625 lines, 2:1 Interlace | 525 lines, 2:1; 625 lines, 2:1 Progressive | 525 lines, 2:1; 625 lines, 2:1 Interlace |
| Image Sensor | 1/3" Interline Transfer CCD | 1/3" WDR digital image device | 1/3" Interline Transfer CCD |
| Number of Pixels (H x V) | 768 x 494 (NTSC); 752 x 582 (PAL) | 720 x 540 | 768 x 494 (NTSC); 752 x 582 (PAL) |
| Minimum Illumination | 0.6 lux @ F1.3 | 0.4 lux @ F1.3 | 0.3 lux @ F1.3 (Color) 0.03 lux @ F1.3 (B/W) (Sens Up) |
| Horizontal Resolution | 540 TVL | | |
| Video Output | 1.0 Vp-p Coax @ 75 Ohms 1.0 Vp-p UTP @ 100 Ohms (All TP models) | | |
| Sync System | 12 VDC: Internal, 24 VAC: Line lock | | |
| S/N Ratio | 50 dB (AGC Off) | | |
| Auto Gain Control | On/off, switchable | Auto (0-36 dB maximum) | On/off, selectable |
| ALC | Direct Drive (DC) Auto Iris (only) | | |
| Automatic Electronic Shutter | 1/60 – 1/100,000 second; 1/50 – 1/100,000 second | | 1/60 – 1/120,000 second; 1/50 – 1/120,000 second |
| White Balance | Selectable ATW/AWC | ATW/AWB/ATW Xtn'd/ Manual | ATW/AWC/Manual |
| Line Lock Phase Adjust | Adjustable line lock vertical phase | | |
| Lens Type | 2.7-13.5 mm Auto or Manual 5-50 mm Auto or Manual | | |
| AI/AES Selection | On/Off Switchable | | |
| Gamma | 0.45 | | |
| Electrical | | | |
| Input Voltage | 12 VDC/24 VAC | | |
| Input Range | 11-16 VDC, 17-28 VAC | | |
| Surge Suppression | 1.5 kW Transient | | |
| Power Consumption | 3.5 W (max) | | |
| Mechanical | | | |
| Dimensions (W x H x D) | See diagram on next page | | |
| Weight | 0.88 lb (0.4 kg) max (camera and lower bubble only) | | |
| Housing Construction | PCABS (Polycarbonate/Acrylonitrile Butadiene Styrene blend) | | |
| Video Output | BNC connector or UTP connector (twisted pair models) | | |
| Power Input | 12-inch tinned leads | | |

SPECIFICATIONS

| Environmental | |
|-------------------|--|
| Temperature | Operating: 14°F to 122°F (-10°C to 50°C) Storage: -4°F to 140°F (-20°C to 60°C) |
| Relative Humidity | 0% to 85% non-condensing |
| Mounts | |
| HD5-MK2 | Flush Mounting Kit |
| HD5-PK | Pendant Mount Kit |
| Regulatory | |
| Emissions | FCC, CE (EN55022) |
| Immunity | CE (EN50130-4) |
| Safety | UL60065, EU LVD 2006/95/EC |

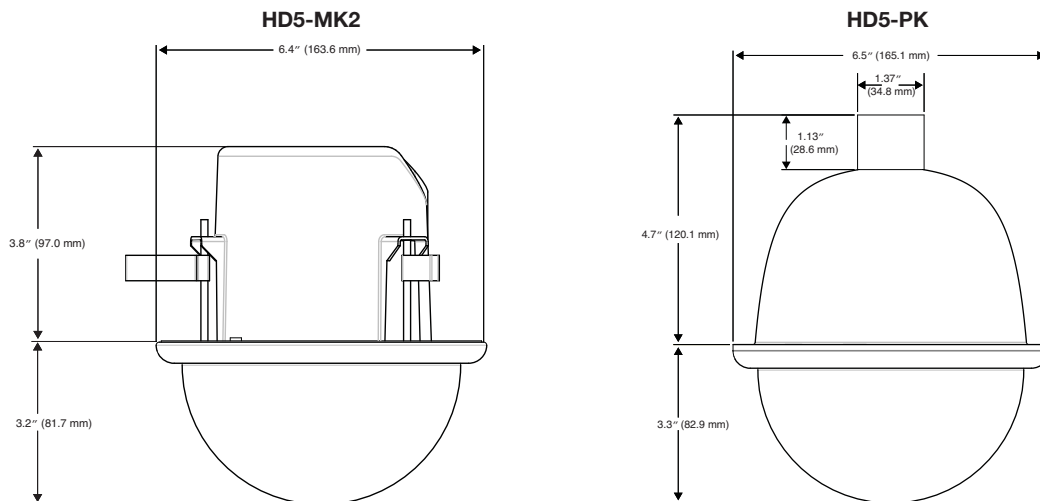

Ordering

| | | HD5 | U | C | 3 | O | N | P | | |
|--------------------|-------|---------------------------|-------|-------|-------|-------|-------|-------|---------------------|----------------------------|
| Model | _____ | _____ | _____ | _____ | _____ | _____ | _____ | _____ | | |
| | HD5 | | | | | | | | | |
| Camera | _____ | _____ | _____ | _____ | _____ | _____ | _____ | _____ | | |
| | C | 540 TVL High Resolution | | | | | | | | |
| | U | 540 TVL Wide Dynamic | | | | | | | | |
| | S | 540 TVL Day/Night DNR | | | | | | | | |
| CAT5 Option | _____ | _____ | _____ | _____ | _____ | _____ | _____ | _____ | | |
| | C | Coax | | | | | | | | |
| | T | UTP | | | | | | | | |
| Lens | _____ | _____ | _____ | _____ | _____ | _____ | _____ | _____ | | |
| | 2 | 2.7-13.5 mm AI Vari-focal | | | | | | | | |
| | 3 | 2.7-13.5 mm MI Vari-focal | | | | | | | | |
| | 5 | 5-50 mm AI Vari-focal | | | | | | | | |
| | 6 | 5-50 mm MI Vari-focal | | | | | | | | |
| | | | | | | | | | Mounting Kit | |
| | | | | | | | | | P | Pendant Mount |
| | | | | | | | | | F | Flush Mount |
| | | | | | | | | | O | None |
| | | | | | | | | | | Format |
| | | | | | | | | | N | NTSC |
| | | | | | | | | | P | PAL |
| | | | | | | | | | | Bubble / Trim Ring* |
| | | | | | | | | | A | Clear Bubble/Black Trim |
| | | | | | | | | | B | Clear Bubble/White Trim |
| | | | | | | | | | C | Smoke Bubble/Black Trim |
| | | | | | | | | | D | Smoke Bubble/White Trim |
| | | | | | | | | | O | No Bubble |

* Gold or Chrome bubble options also available. Contact Inside Sales at 1 800 796 2288 for ordering information.

Automation and Control Solutions

Honeywell Systems
2700 Blankenbaker Pkwy, Suite 150
Louisville, KY 40299
1.800.323.4576
www.honeywell.com

L/HD5D/D
February 2011
© 2011 Honeywell International Inc.

Honeywell