

DH-CA-D460BP/N

High Resolution Zoom Dome Camera



DH-CA-D460BP: 540TVL, 4~9mm zoom, Auto Iris, PAL
DH-CA-D460BN: 540TVL, 4~9mm zoom, Auto Iris, NTSC

Features

- 1/3" SONY Super HAD II CCD
- High resolution of 540TVL
- Mini. Illumination of 0.1Lux/F1.4
- Auto Electrical Gain control
- Auto White Balance
- Auto Electronic Shutter
- Backlight Compensation
- High Signal to Noise Ratio (SNR)
- 4~9mm Zoom Auto Iris lens
- Support Pan/Tilt rotation

Dimensions (mm)

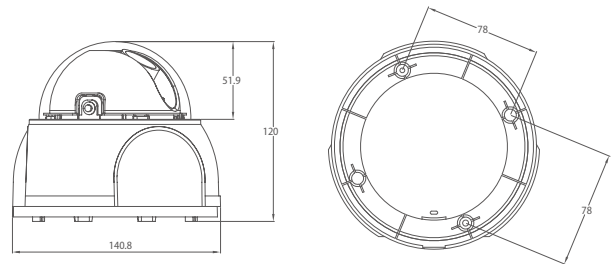

Specifications

Model	DH-CA-D460BP	DH-CA-D460BN	
Camera	Image Sensor	1/3" SONY Super HAD II CCD	
	Video Format	PAL	NTSC
	Effective Pixels	752(H) x 582(V), 440K pixels	768(H) x 494(V), 380K pixels
	Horizontal Resolution	540TVL	
	Mini. Illumination	Color: 0.1Lux/F1.4	
	Electronic Shutter	1/50s~1/100,000s	1/60s~1/100,000s
	S/N Ratio	>52dB(AGC Off)	
	White Balance	Auto	
	Gain Control	Auto	
	BLC	Auto	
	Synchronization	Internal	
	Video Output	1Vp-p Composite Output (75Ω/BNC)	
Lens	Focal Length	4~9mm	
	Auto Iris	Yes	
General	Power Supply	DC12V±10%	
	Power Consumption	2.5W	
	Working Temperature	-10°C~+60°C	
	Dimension	Φ140.8mm x 120mm	
	Weight	400g	